

26427 MICROCEMENT ELEMENT OBLONG DINING TABLE ASSEMBLY INSTRUCTIONS FOR TABLE INSTALLATION

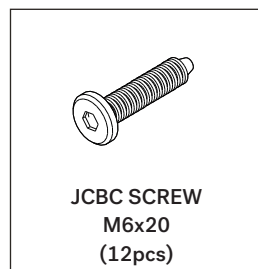

HARDWARE ENCLOSED



TOOL ENCLOSED

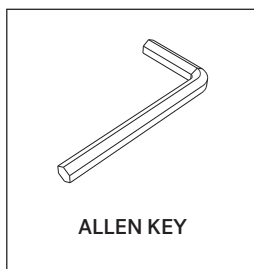

IN YOUR PACKAGE :

ASSEMBLY INSTRUCTIONS
HARDWARE (AS LISTED ABOVE)

PARTS TO BE INSTALLED

1. TABLE TOP (1pc)
2. LEG BASES (2pcs)

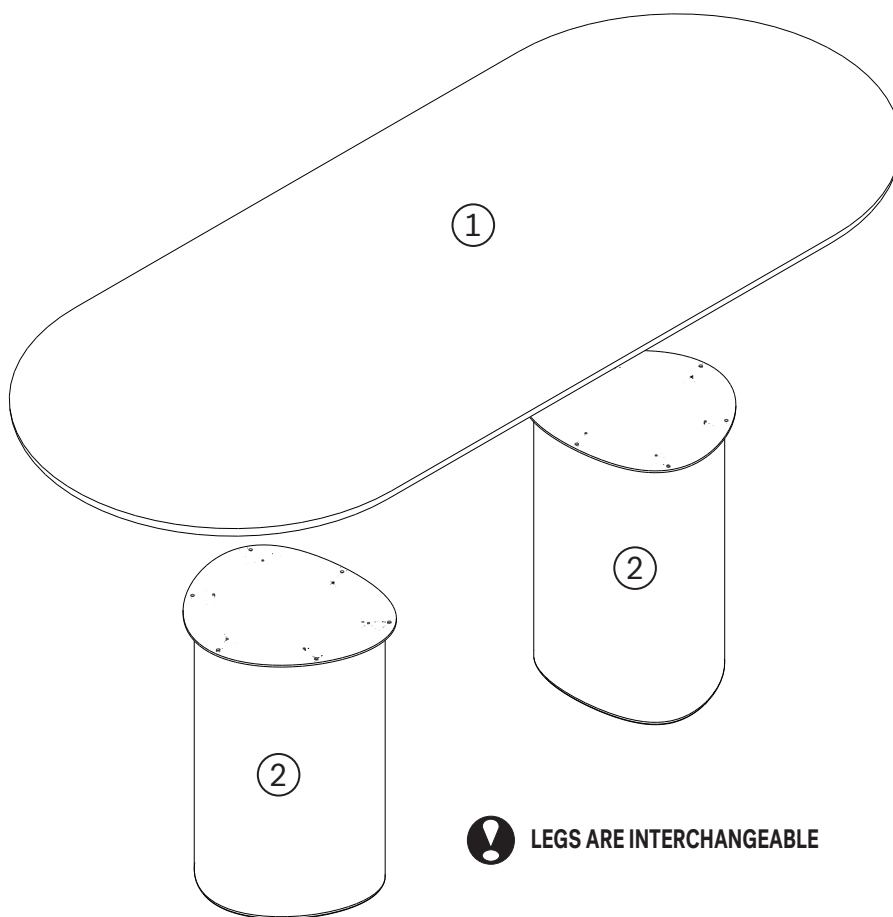

LEGS ARE INTERCHANGEABLE

SYMBOLS



DIRECTION

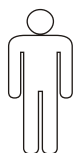

NUMBER OF
PERSONS NEEDED



USE HAND

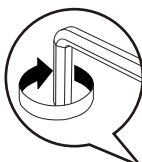

USE ALLEN KEY
TO TIGHTEN

NOTICE

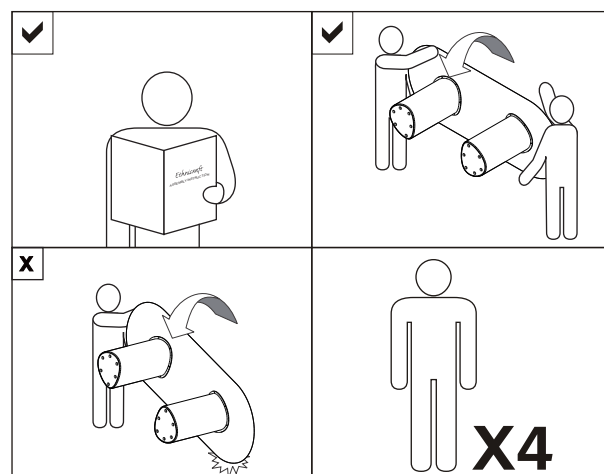

26427 MICROCEMENT ELEMENT OBLONG DINING TABLE ASSEMBLY INSTRUCTIONS FOR TABLE INSTALLATION



A ATTACHING LEG BASES TO TABLE TOP

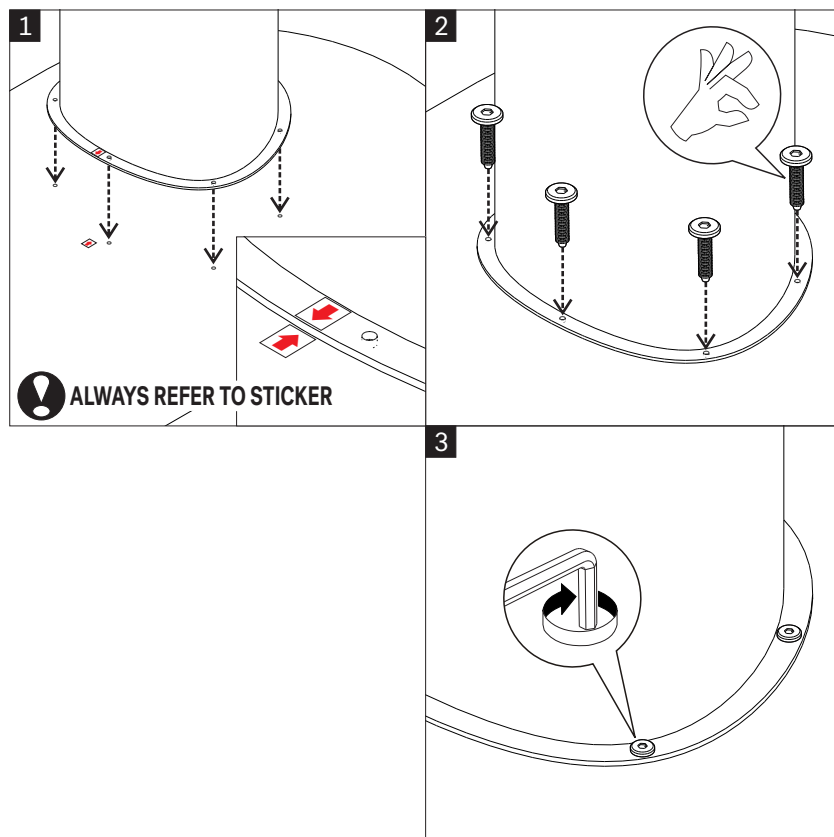
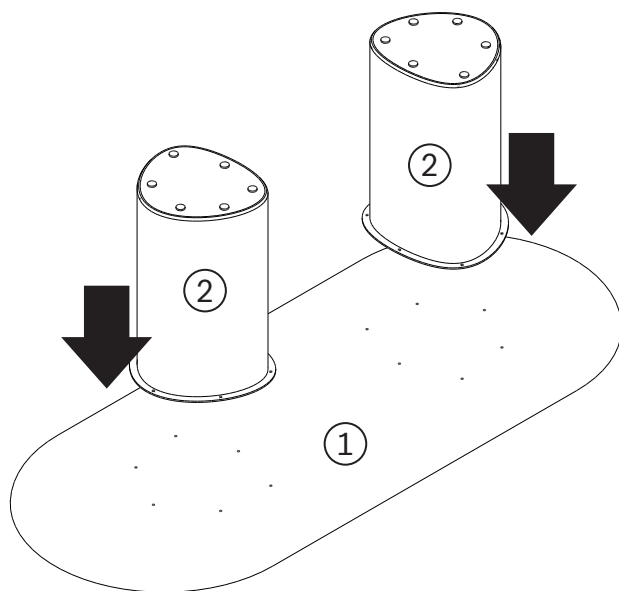

! REMOVE CONTENTS TO LAY OUT ON THE FLATTENED CARTON, CARPETED AREA OR ANOTHER PROTECTIVE SURFACE TO AVOID DAMAGE WHILE ASSEMBLING.

**! - ALIGN SCREW HOLES FOR CORRECT PLACEMENT
- USE JCBC SCREW M6x20 (12X)
- TIGHTEN FULLY**

B MODIFY THE ADJUSTABLE GLIDES

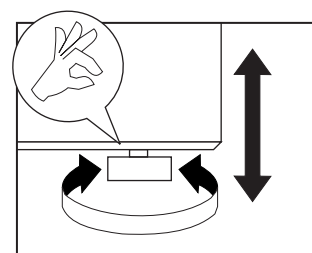
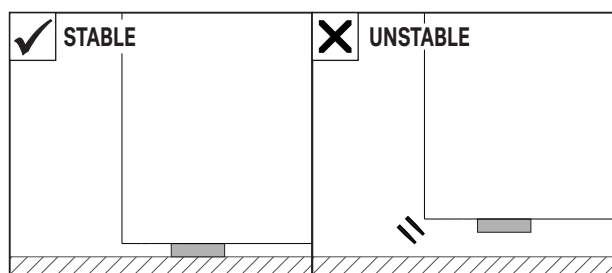
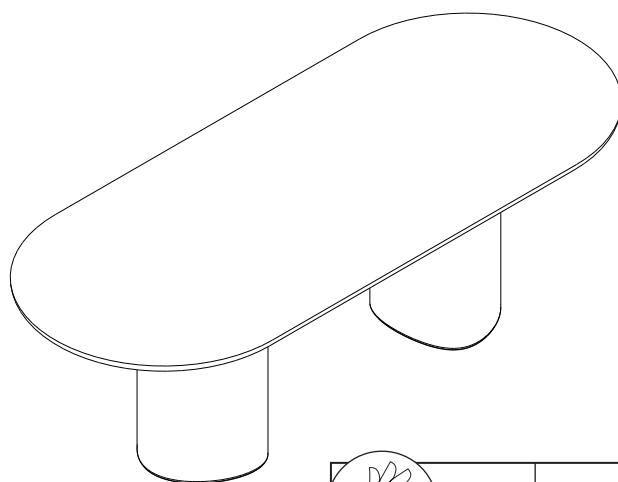
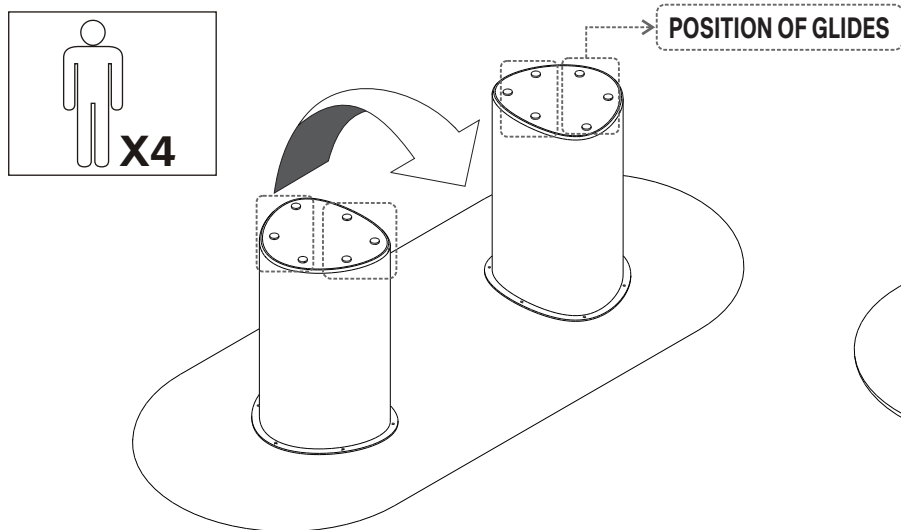

NOTE :
TO ENSURE STABILITY, ALL GLIDES SHOULD BE ADJUSTED TO MAKE EVEN CONTACT WITH THE SURFACE UNDERFOOT.